

<住宅平面図>

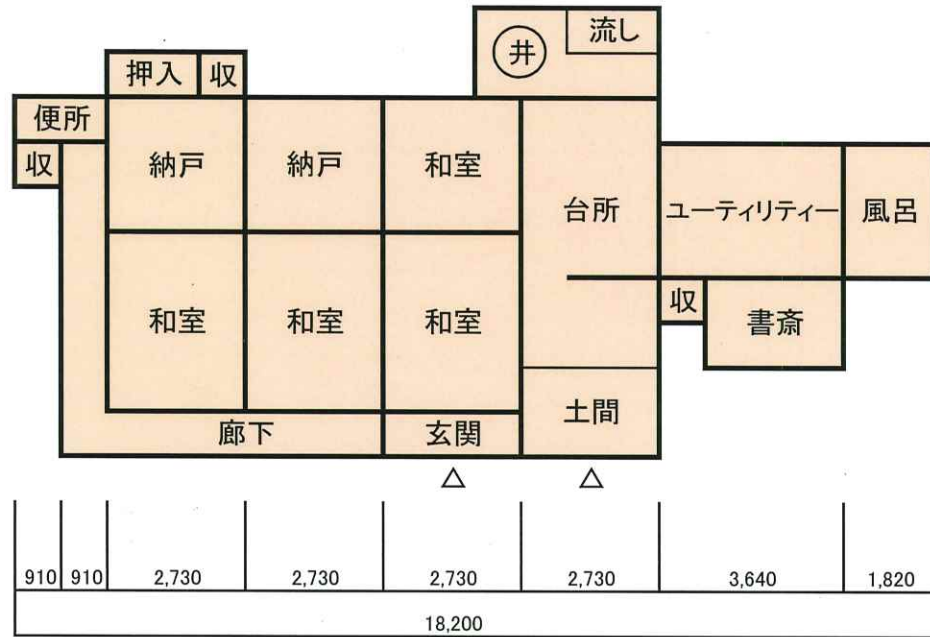

	1,820
	910
	2,730
	1,820
	7,280
	1,820

<物置平面図>

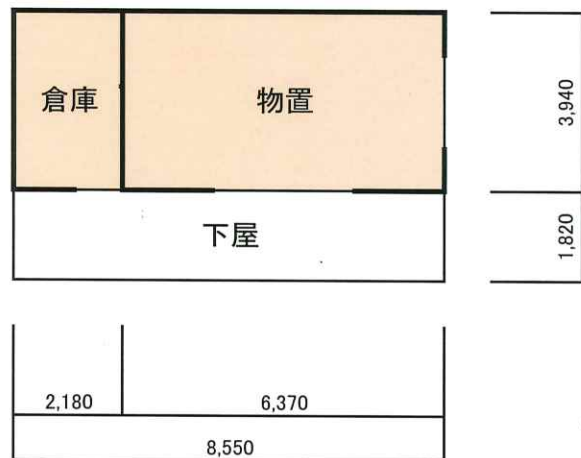

■ 床面積

$$8.55 \times 3.94 = 33.687 \text{ m}^2$$

<肥料舎平面図>

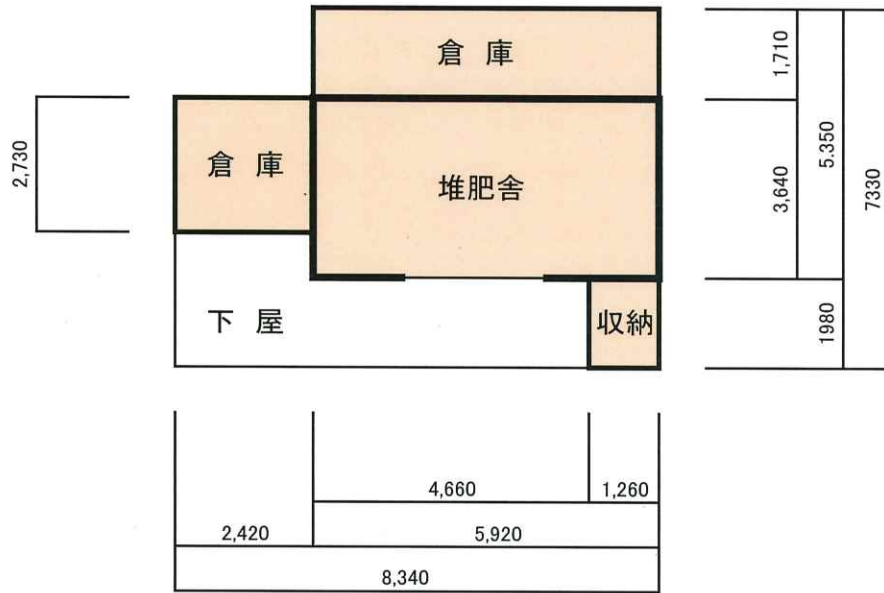

■ 床面積

$$2.42 \times 2.73 + 5.92 \times 5.35 + 1.26 \times 1.98 = 40.7734 \text{ m}^2$$